

Commercial Reduction Gearbox Installation

Note: You may need to replace the Y piece if it hasn't got the tapped fixing holes for the Y piece to screw down the Y piece cap as shown in steps 8 and 10.

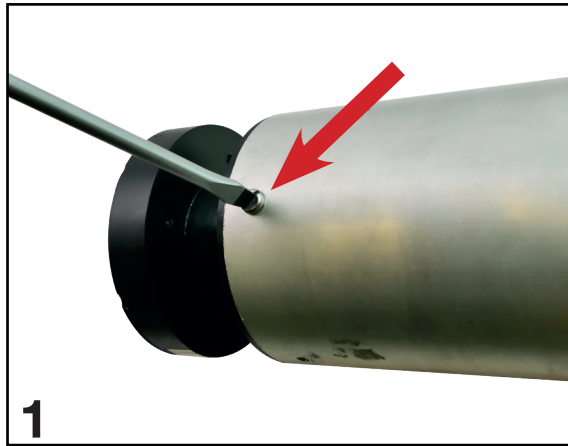

Unscrew the four fixing screws from the boss you're going to replace.



Remove tube from endstand and support the tube safely.

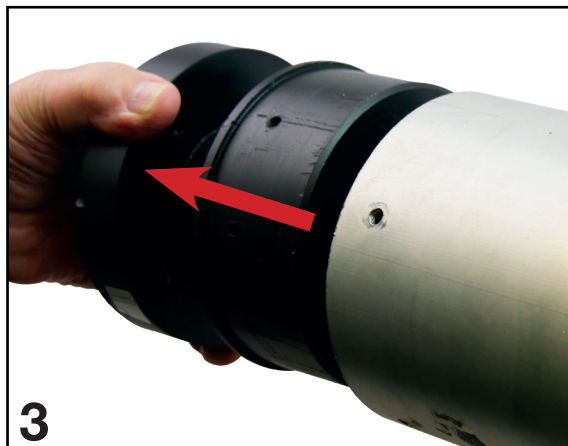

Remove the boss from the tube.

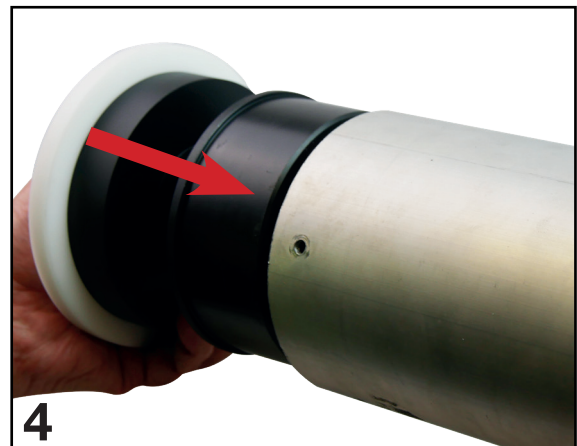

Insert Commercial Gearbox unit into tube.

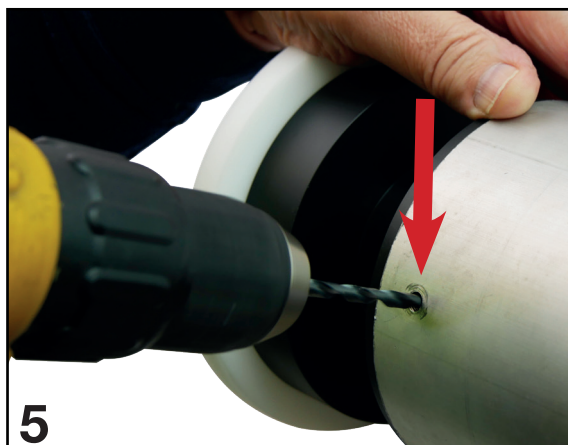

Drill Ø 4.2 x 30 deep and tap M5.

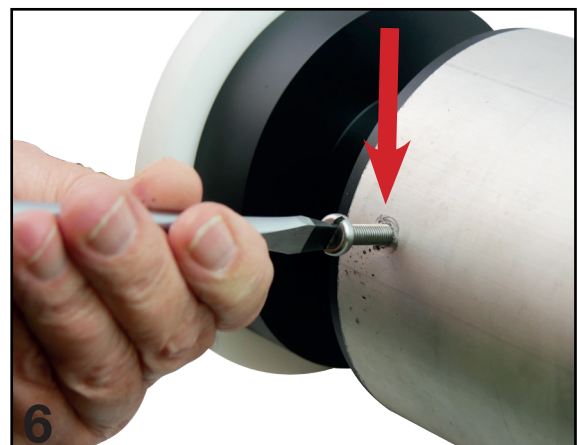

Use supplied M screws to fix unit to tube.

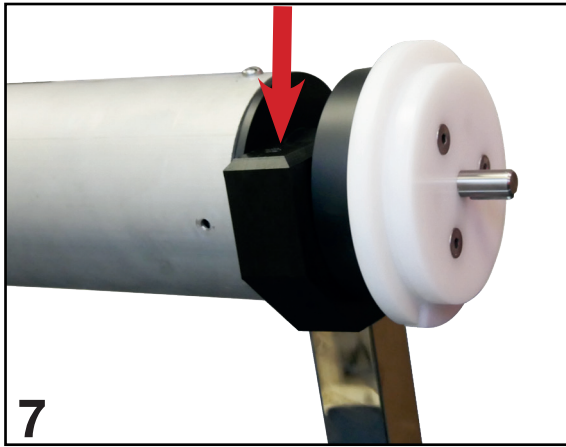

7 Place gearbox unit into commercial 'Y' piece.

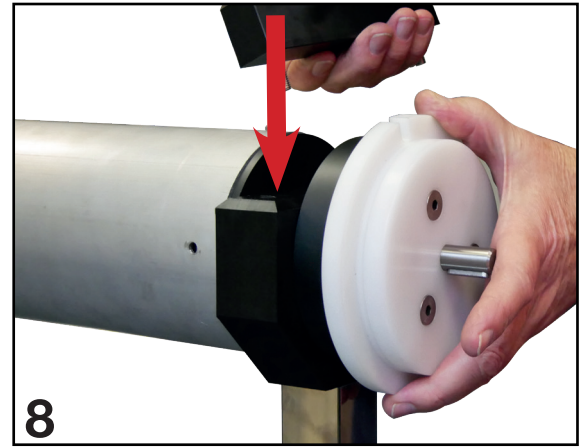

8 Place retaining cap onto 'Y' piece. Taking note, the orientation of the gearbox in relation to retaining cap and ring gear stopper.

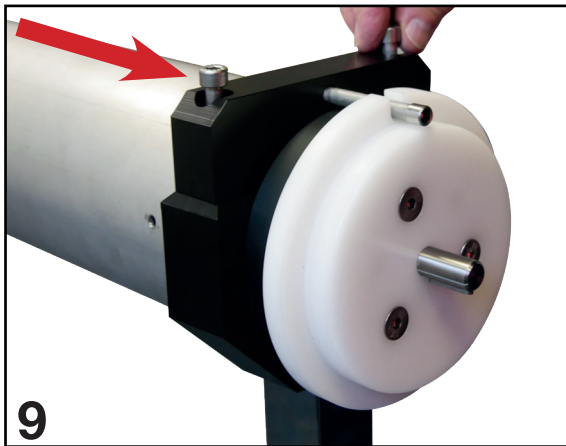

9 Using bolts supplied bolt on Retaining Cap onto Y piece.

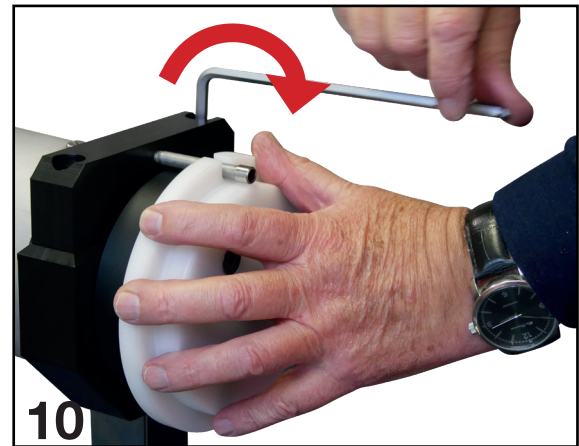

10 Tighten cap to Y piece using 6m Allen key.

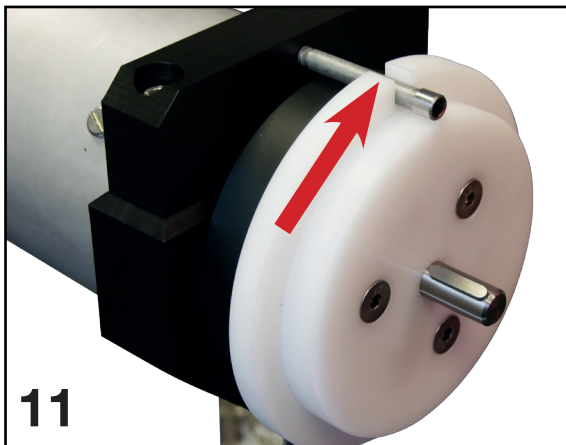

11 Take note of the position of the rotation stopper.

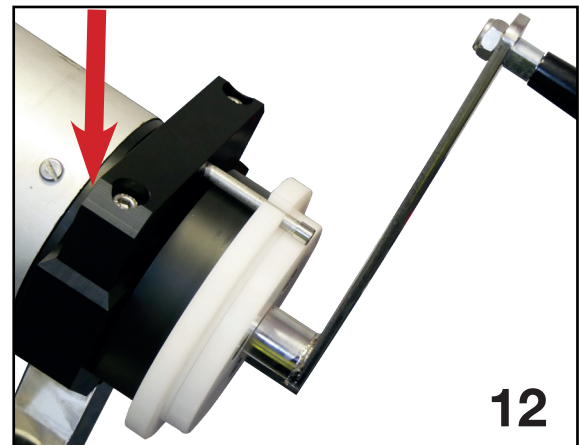

12 Place handle over the shaft, taking note of the keyway in the handle and key on the shaft.

 **Plastica**

The UK's Leading Independent Swimming Pool Manufacturer and Distributor

 www.plasticapools.net Find us on     