

Q-VAC Q3

THE QUIET VAC

OWNER'S MANUAL

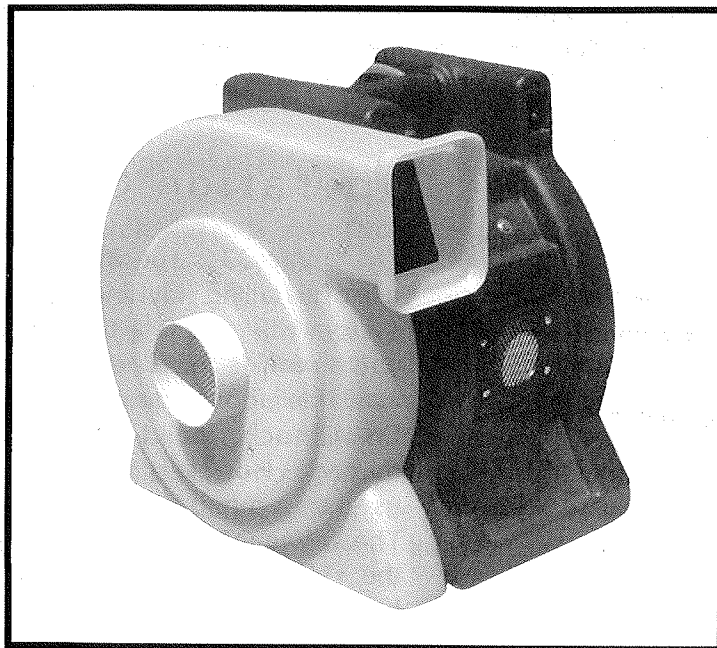

Q-Products
Intelligent Products Making Life Easier

P.O. Box 2053
Blairsville, GA 30514-2053 - USA

SUPER QUIET • SUPER SUCTION • SUPER DESIGN

Table of Contents

Introduction.....1	Q-VAC Q3	Grounding Instructions..... 3
Overview.....1		Operation..... 4
Applications..... 1		Exploded Parts View..... 5
Safety.....2		Warranty Information..... 6

Introduction

Thanks for purchasing the new Q-Vac Q3. This third generation Q-Vac has been redesigned to be an even more dependable than the original Q-Vacs. After ten years of experience we wanted to exceed our customers expectations by producing a new Q-Vac that provides lighter weight design, with improved durability and better performance. Listed below are the improvements made over the original. At Q-Products we want you to be 100% completely satisfied with your new product. We welcome all comments and input you have to make our product even better. Please contact us toll free at 1-887-381-9553 or email us at qproducts@alltel.net.

GET THE Q-VAC Q3 ADVANTAGE...

Lighter Weight Design	35lbs. vs 45lbs. - make transporting easier
Ergonomic Handle	Handle located on the side for better balance and easier transporting
Unit Fully Assembled	No labor required - no loose or missing parts
New! Unbreakable Ports (New Port Design)	Metal and rubber design eliminates damage to input and exhaust flange
Soft Rubber Feet	Better grip and more durable than hard plastic
Stronger Tubular Frame	Prevents damage to unit during transport
Aluminum Cooling Fan	Stronger more durable fan blades
Aluminum Blower Fan	Creates more air flow by not flexing like old style plastic impellers
Improved On-Off Switch	Metal toggle switch replaces the plastic switch box

Operation Overview

The Q-Vac Q3 is specifically designed for the commercial use of installing vinyl lined swimming pools. Your Q-Vac Q3 system will evacuate the air from behind the liner giving you a wrinkle free liner installation. Extra long hoses are available upon request for special situations. The Q-Vac Q3 will suck ground water and will not be hurt from water damage. However, the Q-Vac Q3 is not intended to be used as a pump to pump water out from behind the liner. The Q-Vac Q3 will work in either over the wall or through the skimmer installation. Each application is described below.

Over the Deck Application

In this application the Q-Flex hose is placed behind the liner by pulling a 6' length of the liner from the liner receiver and placing the Q-Flex hose down behind the liner. Then use duct tape to close up any gaps between the liner and wall so there are no suction leaks around the Q-Flex hose.

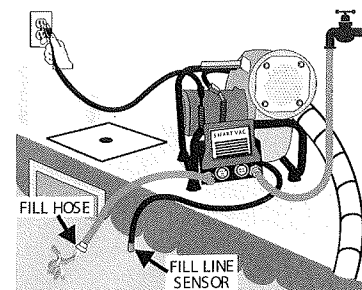

Through the Skimmer Application

In this application the Q-Flex hose is placed down through the skimmer hole in the deck. Feed hose through the skimmer mouth and between the liner and the wall of the pool. Even though you are making many bends in the hose, you will still have plenty of suction.

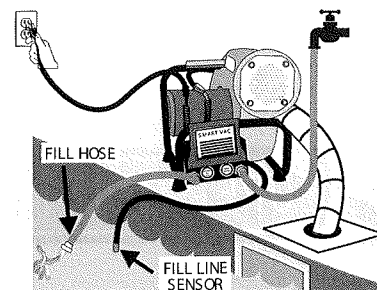

Safety



IMPORTANT SAFETY INSTRUCTIONS

Read this safety section carefully to learn how to operate and maintain your product correctly. Reading this manual will help you and others avoid personal injury and damage to the product. Although Q-Products designs, produces and markets safe, state-of-the-art products, you are responsible for using the product properly and safely. You are also responsible for training persons about product safety when you authorize others to use your Q-Vac Q3.

- Pay particular attention to the safety alert symbol **< ! >** which means caution, warning, or danger personal safety instruction.

Failure to comply with these instructions may result in personal injury and/or property damage, risk of fire, or electrical shock.

SAVE THESE INSTRUCTIONS FOR FUTURE REFERENCE

< ! > **WARNING** - To reduce the risk of fire, electrical shock or injury follow these safety instructions.

1. Keep everyone, especially children and pets, away from the area of operation. Never allow anyone to operate the product without having read the owners manual first.
2. This unit is not waterproof. Do not leave unit set in a hole or bucket where water can puddle and seep through the switches and fittings. If you think water has entered the control unit then return the unit to the factory for repair. If the control unit was working and failed always disconnect the power before approaching the unit. Once the power is disconnected, shake the unit to determine if there is any water inside the enclosure. It is possible that you may not hear the water moving around when shaken if the enclosure is completely filled, however you should feel a noticeable weight difference. If water is believed to have entered the control unit, return to the factory for repair. There are only two ways for water to enter the control unit, a leaky valve or unit left in standing water.
3. To reduce the risk of electrical shock use only an approved UL (CSA in Canada) extension cord recommended for outdoor use. Refer to the extension cord chart on page 4. Replace damaged extension cords immediately.
4. Don't abuse cord. Do not pull or carry unit by cord. Do not use the cord as a handle. Do not unplug control unit by pulling the cord.
5. Keep cord away from extreme heat, oil or sharp edges. Replace damaged cords.
6. Do not operate in an explosive atmospheres. Such as in the presence of flammable liquids, gases or dust. Electrical devices create spark which may ignite dust or fumes.
7. Do not handle plug or control unit with wet hands or while standing in water.
8. Do not use control unit with damaged cord or plug. If control unit is not working as it should, or dropped in water, return the unit to an authorized dealer for service.
9. Always stop the vacuum motor before unplugging the supply cord, and when making any repairs or inspections.

< ! > Grounding Instructions

Q- VAC Q3 SPECIFICATIONS

Supply Voltage 110VAC 60HZ
 Maximum Current Load: 13 amps
 Operating Water Pressure Range: 15-100 PSI
 Valve Opening Time: 5 seconds (max)
 Closing Time: 60 seconds (max)
 Flow Range: 0.5 - 15 GPM
 Air Flow: 650 CFM
 Horsepower: 1 HP

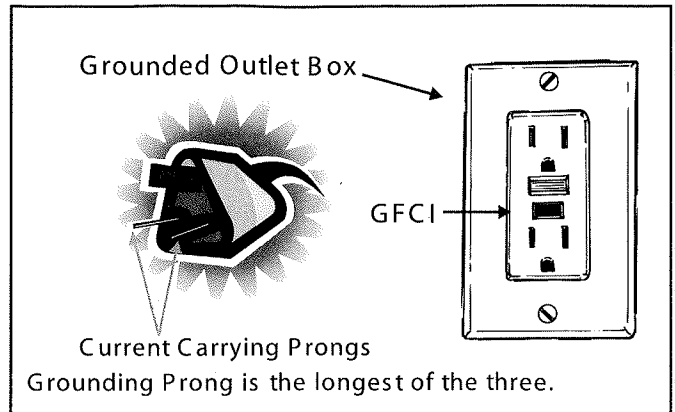

This instrument must be grounded while in use to protect the operator from electrical shock. The tool is equipped with a 16 AWG three-conductor chord with a three pronged grounding type plug to fit the proper grounding type receptacle. The green (or green and yellow) conductor in the chord is the grounding wire. Never connect the green (or green and yellow) wire to live terminal.

In all case make sure the receptacle and plugs in question are properly grounded.

Never remove grounding prong from power plug.

Always use a power receptacle with a Ground Fault Circuit Interrupter (GFCI).

We sell portable in-line GFCI cord sets for customers who install pools in older homes that do not comply with new outdoor home receptacle regulations. For more information please call your nearest dealer for availability and pricing. Electrical supply stores also carry them.

Extension Cords

Use only three wire extension cords, which have three pronged grounding type plugs, and three pole receptacle which will accept the instruments three prong plug. Replace a damaged or worn cord immediately. Do not attempt to repair power cord.

RECOMMENDED SIZES OF EXTENSION CORDS

		Tools Ampere Rating				
Amp	Feet	15'	50'	100'	150'	
3-6		18	16	16	14	AWG
6-8		18	16	14	12	AWG
8-10		18	16	14	12	AWG
10-12		16	16	14	12	AWG
12-16		14	12	N/A	N/A	AWG

Q-Vac Q3 Operation

Operators are responsible for knowing all electrical codes and safe operating procedures for using electrical devices in hazardous operating environments. The intent of the following procedures is not to instruct operators of safe operating procedures but simply to remind operators of the hazards involved.

Choosing a Proper Location During Operation

For maximum performance, we have found through 10 years of use that proper Q-Vac Q3 placement for operation is a key to great results.

It is very important to place Q-Vac Q3 2 to 3 feet from deep end wall, on long wall of pool - see diagram below

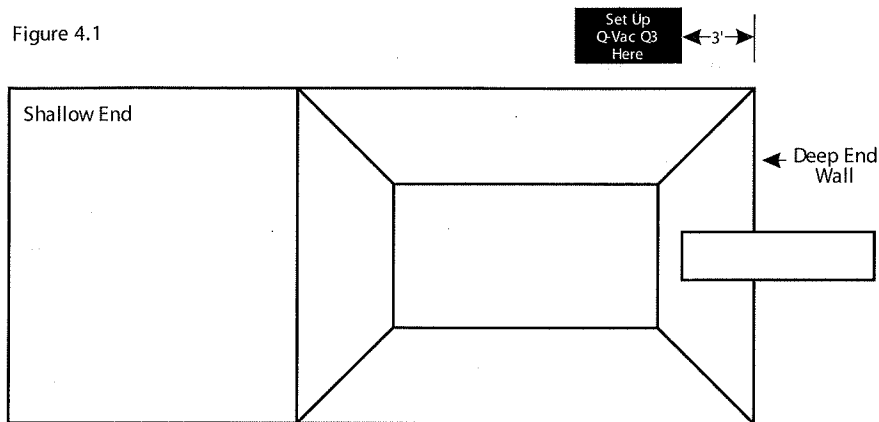

Proper Q-Vac Q3 placement during operation is important because:

1. In the deep end of the pool, the side slope of the pool floor meets the pool wall and creates a natural pocket for the adapter hose. This natural pocket allows the adapter hose to suck out the air, without sucking up the liner into the hose, which eliminates the suction of air from behind the liner.
2. By positioning the Q-Vac Q3 in the deep end of the pool, you are placing the vac where the majority of the air is that needs to be sucked out. This occurs because in 90% of vinyl liner pools, the deep end of the pool is 75% of the pool area, while the shallow end is only 25%. You need the Q-Vac Q3 to be where the air is.
3. When placing the Q-Vac Q3 in the shallow end, or anywhere near the break line we have found that the liner will seal off the air flow to the Q-Vac Q3. This occurs because of the 90 degree corner where the pool floor meets the pool wall. Once the liner is sucked back against the wall, the air flow is eliminated and no air can get sucked out from behind the liner.

Always position Q-Vac Q3 2 to 3 feet from deep end wall, on long wall of pool for maximum performance.

Proper Connections for Operation

Locate safe dry area as specified above.

Slide rectangular end of the Q-Flex hose down between the liner and the pool wall.

Adjust Q-Flex hose so the bottom of hose is 3-4" from the pool floor

Apply duct tape around the opening where the Q-Flex hose is inserted behind the liner. Seal this opening to avoid any air leaks behind the liner.

Q-VAC PARTS EXPLODED VIEW

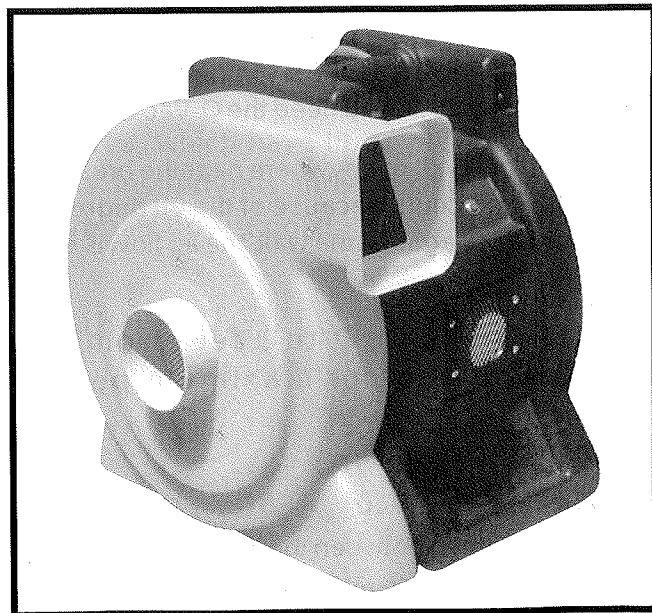
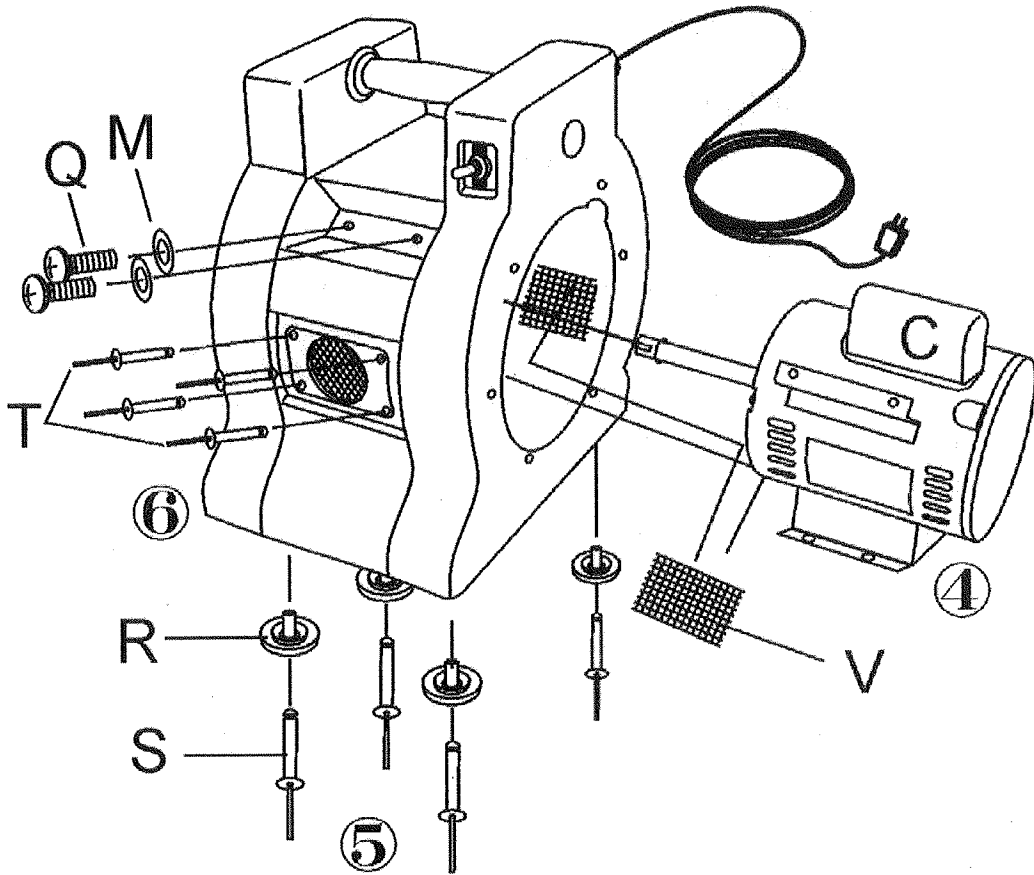

Limited Warranty

※ *DURATION*: One year from the date of purchase by the original purchaser.

※ WHO GIVES THIS WARRANTY (WARRANTOR):

**Q-PRODUCTS
P.O. BOX 2053
BLAIRSVILLE, GA. 30514-2053
877-381-9553**

※ WHO RECEIVES THIS WARRANTY (PURCHASER): The original purchaser, except for purposes of reselling of the Q- Vac product.

※ WHAT PRODUCTS ARE COVERED BY THIS WARRANTY: Any Q-Vac product supplied or manufactured by Warrantor.

※ WHAT IS COVERED UNDER THIS WARRANTY: Defects in material and workmanship, which occur within the duration of the warranty period.

※ WHAT IS NOT COVERED UNDER THIS WARRANTY:

- A. Implied warranties, including those of merchantability and FITNESS FOR A PARTICULAR PURPOSE ARE LIMITED TO ONE YEAR FROM THE DATE OF ORIGINAL PURCHASE. Some states do not allow limitations on how long an implied warranty lasts, so the above limitations may not apply to you.
- B. ANY INCIDENTAL, INDIRECT, OR CONSEQUENTIAL LOSS, DAMAGE, OR EXPENSE THAT MAY RESULT FROM ANY DEFECT, FAILURE, OR MALFUNCTION OF THE Q-Vac PRODUCT, Some states do not allow the exclusion or limitation of incidental or consequential damages, so the above limitation or exclusion may not apply to you.
- C. Any failure that results from an accident, purchaser's abuse, neglect of failure to operate products in accordance with instructions provided in the owner's manual (s) provided with the product.
- D. Normal adjustments which are explained in the owner's manual (s) provided with the product.
- E. Items or service that are normally required to maintain the product.

※ RESPONSIBILITIES OF WARRANTOR UNDER THIS WARRANTY. Repair or replace, at Warrantor's option, products or components which have failed within duration of the warranty period.

※ RESPONSIBILITIES OF PURCHASER UNDER THIS WARRANTY:

- A. Deliver or ship the Q-VAC product to the nearest Q-Vac Authorized Service Center. Freight costs, if any, must be borne by the purchaser.
- B. Use reasonable care in the operation and maintenance of the products as described in the owner's manual (s).

※ WHEN WARRANTOR WILL PERFORM REPAIR OR REPLACEMENT UNDER THIS WARRANTY:

- A. Repair or replacement will be scheduled and serviced according to the normal work flow at the servicing location, and depending on the availability of replacement parts.

This Limited Warranty gives you specific legal rights and you may also have other rights, which vary from state to state.