



CLEAR WATER

AUTOMATIC OFFLINE CHLORINATOR

INSTALLATION INSTRUCTIONS

SAVE THESE INSTRUCTIONS

Read all instructions prior to assembly

NOTE: NOT FOR USE IN COPPER PLUMBING

- POSITION the CHLORINATOR: The ClearWater Off-Line Chlorinator must be installed in the pool return line. To prevent damage from high concentrations of chlorine, locate in return line between pool and any other components of the circulation system, including heater, filter and pump. (See installation diagram 2.)
- TURN PUMP and FILTER SYSTEM OFF
- SHUT VALVES

Installation with a Waterway Cartridge or DE Filter System The chlorinator must be installed in a vertical and upright position (lid up). All Waterway Cartridge and DE systems include couplers for chlorinator installation. Drill out 3/8" barbs and clean debris. Attach tubing, P/N 872-2240 with clamps, P/N 872-2291. See diagram 2.

Installation without a Waterway System

The chlorinator comes equipped with fittings required for installation. Assemble Gasket, P/N 806-0003 onto smooth barb of 3/8" Pipe Adapter, P/N 425-1181. Position Adapter through clearance hole of Hose Clamp, P/N 872-0011. Using a 3/8" bit, drill return line and position 3/8" Pipe Adapter and clamp around return line. Push smooth barb into return line. Note: make sure curvature on adapter and gaskets seats flush with curvature of clamp and return line to assure proper sealing. Repeat above for feeder inlet line. Cut tubing, P/N 872-2240 to proper length. Apply Teflon tape to Off-Line Valve Assembly, P/N 600-0101 prior to assembly. Connect feeder inlet line, with Hose Clamp, P/N 872-2291 to Off-Line Valve Assembly, P/N 600-0101. Connect feeder outlet to Bottom Check Valve Assembly, PN 600-1151 and to return line, positioned after pool heater, using hose clamp, P/N 872-2291. To prevent damage to the pool heater, install a corrosion-resistant swing check valve on the return side in between the pool heater and chlorinator. See diagram #3. Make sure arrow of check valve is pointing away from equipment and in direction of water flow to the pool. Do Not over-tighten fittings.

To allow for adding chlorine and servicing when installing below pool's water level, gate or ball valves must be installed on both sides of chlorinator.

NOTE: When installing a heater, a FIREMAN'S SWITCH or equivalent must be installed to prevent heat damage to Check Valves and other equipment.

Chlorine levels should be checked periodically to monitor the amount of chlorine in the water. Refer to OPERATING INSTRUCTIONS to properly set chlorine level.

To ensure continuous peak performance, periodic maintenance may need to be performed. Prior to servicing:

- TURN PUMP and FILTER SYSTEM OFF
- SHUT VALVES
- Loosen and remove lid. Lift screen from bottom of chlorinator.

The Bottom Check Valve Assembly located at bottom of chlorinator body may be removed and cleaned. Clean parts with a brush, hose or other high pressure device. Use protective eye wear. Use Teflon tape when replacing valve assemblies. Do Not over-tighten.

Calcium deposits indicate a high spa / pool PH and should be corrected by adding acid in very small amounts until PH reads between 7.2 and 7.6. (7.4 is ideal.) If condition persists consult a pool / spa serviceman in your area who is familiar with local water conditions and can correct them for you.

OPERATING DIRECTIONS

Read all instructions prior to operation.



ALWAYS Follow Manufacturer's Directions.

SAFETY: Care must be used. Use gloves and eye protection. Do Not Smoke. Do Not Inhale Fumes

TO INSTALL TABLETS:

1. Shut off pump and close valve on inlet side of Chlorinator.
2. Slowly rotate lid by turning counterclockwise.
3. If refilling with chemicals – allow fumes to escape. See product label for specific warnings and information.
4. Place chlorine tablets inside of canister. Be certain that first tablet is seated flat on top of screen. **DO NOT stack tablets above fill line, top of canister.**
5. Before re-fastening lid, make sure that O-Ring is clean and seated securely in lid.
6. Hand tighten lid. **DO NOT over-tighten.**

TO OPERATE:

- OPEN INLET VALVE
- TURN PUMP AND FILTER SYSTEM ON
- CHECK FOR LEAKS

SETTING KNOB CONTROL:

1. Some trial and error will be required to establish proper setting for use and filter cycle time will all affect control knob setting.
2. Start by turning knob to mid point on indicator.
3. Allow one to two days for the chlorine level to stabilize.
4. Check chlorine level with a test kit.
 - If level is below 1 ppm – try a higher setting
 - If level is above 2 ppm – try a lower setting
 Repeat these steps until proper setting is found.

NOTE: The ClearWater Chlorinator is not designed for shock treatment of pools. See your dealer or distributor for information concerning shock treatments.

LEVELS: pH: 7.2 – 7.6
Alkalinity: 80 – 100ppm

IMPORTANT: IT WILL NOT BE POSSIBLE TO MAINTAIN A PROPER LEVEL IF ABOVE LEVELS ARE NOT MAINTAINED OR IF PROPER SHOCK AND STABILIZERS ARE NOT USED.

If your pool has any of the following equipment special plumbing procedures must be followed for safe operations:

- Brass or bronze gate, rotary or backwash valves
- The preceding valves constructed of PVC or other plastic material with metallic shafts
- Filters, heaters, heat exchanges or other items with metallic tanks, shafts, coils or tubes.

Optional Extension Use

If desired, Extension, P/N CLX012, may be used to increase capacity an additional eight (8) tablets.

To Use: Turn System Off. Follow Safety Precautions

- Remove Lid
- Position O-Ring on extension and hand tighten extension. Do Not over-tighten
- Fill Chlorinator with tablets
- Before re-fastening lid make sure O-Ring is clean and seated securely in lid
- Follow Operating Instructions

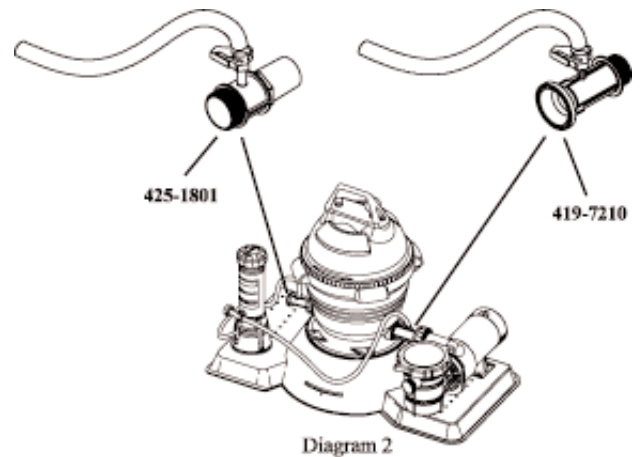
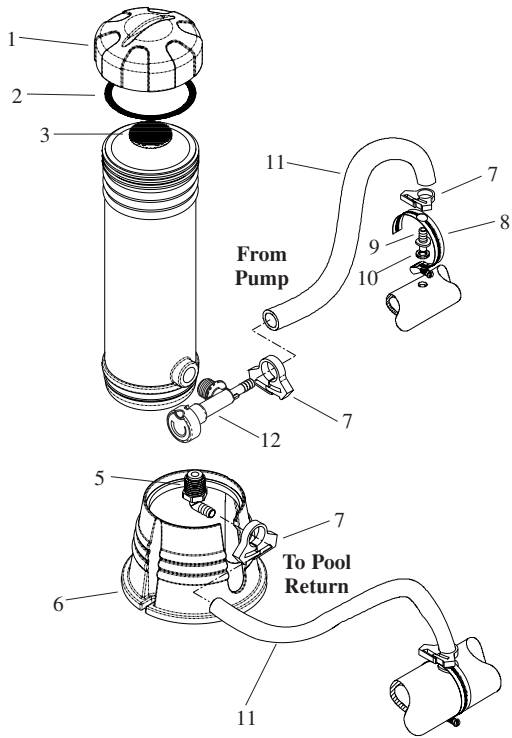

Diagram 2
Chlorinator Installation
with Waterway Cartridge and DE Systems

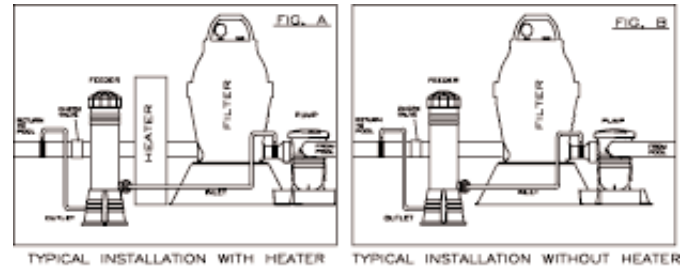
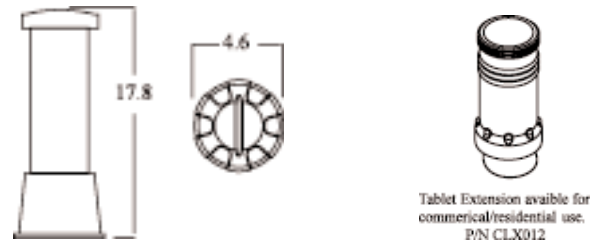

Diagram 3

Replacement Parts

Item	Part Number	Description
1	519-1181	Lid
2	805-0237V	O-Ring, Lid
3	319-0041	Filter Screen
4	515-1188	Body, Clear
	515-1180	Body, White
5	600-1151	1/2" NPT x 3/8" Bottom Check Valve Assembly
6	672-1181	Base, Clearwater Chlorinator
7	872-2291	3/8" Hose Clamps
8	872-0011	Hose Clamps 2 1/2" - 3/16", S/S
9	425-1181	3/8" Pipe Adapter
10	806-0003	Gasket, .750OD x .35ID x .125THK
11	872-2240	3/8" ID x 1/2" OD x 8' L Tubing
12	600-0101	Off-Line Valve Assembly
13	810-0088	Instruction Sheet



BEFORE PERFORMING ANY MAINTENANCE BE SURE SYSTEM IS OFF!

WARNINGS! READ AND FOLLOW ALL INSTRUCTIONS! SAVE THESE INSTRUCTIONS!

WARNING! To reduce the risk of injury and product damage:

This feeder is designed to use only Chlorine (Trichloro-s-triazinetrione) or Bromine (Bromochloro -5, 5 Dimethylhydantoin) tablets, slow dissolving type. **UNDER NO CIRCUMSTANCES MIX Trichlor OR Bromine with Calcium Hypochlorite, with other forms of concentrated chlorine or with other chemicals FIRE AND/OR EXPLOSION MAY RESULT. NEVER** use oils or grease to lubricate O-ring. Oil in contact with Trichlor OR Bromine may result in **FIRE**. Caution should be used when removing feeder cap. **Do not inhale fumes.** If shock treatments or Algacides containing chemicals other than sanitizer tablets in feeder must be used, then **turn off feeder OR remove tablets until the shock or Algae treatment is complete and all granules have dissolved.** Failure to do so may result in granules mixing in feeder causing **FIRE AND/OR EXPLOSION.** The shock or algae treatment dissolved in water is safe with tablets. Always wear protection for eyes, skin and clothing when working with chemicals. Do not smoke and avoid sparks and open flames. Turn off pump and control valve before opening chlorinator. Use of bulk chemicals may result in damage to pool. Chemicals will dissolve very quickly and may cause bleaching to liner due to over-chlorinating, possibly causing unsafe pool conditions. Settings in excess of the recommended control setting levels for the chlorinator can result in excess chlorine being discharged in your pool. This can result in bleaching or discoloration of areas around the pool inlet or in some cases bleaching of the entire pool liner or paint. (Check chemical residuals regularly.)

Limited Warranty:

Waterway Plastics manufactures its products and equipment in accordance with very high standards of workmanship. We use the best materials available and maintain the highest quality procedures practical in the industry. In accordance, Waterway warrants its products as follows:

All plastics parts such as jets, valves, skimmers, manifolds, suction, lights and other plastic components manufactured by Waterway will be replaced or repaired if the defects are determined by Waterway to be the responsibility of Waterway Plastics for a period of THREE YEARS from the date of manufacture. The warranty does not cover Filter cartridges, DE grids, O-rings, Pressure gauges, Pump seals, Light bulbs, or any parts not manufactured by Waterway.